



# AXA HOME SECURITY

## Rim lock 3012

EN



## Information

You have just acquired a high quality AXA product. The instructions below must be followed closely in order to effectively install and operate this product.

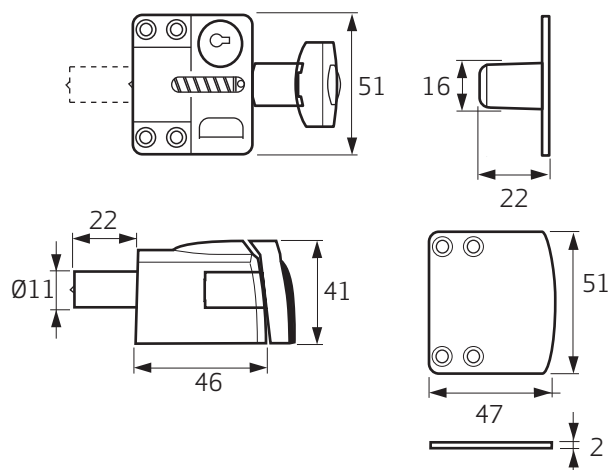

### Application

Outward opening doors, windows and slide doors

### Installation tools (recommended)

Tape measure, (battery) drill, screwdriver, drill  $\varnothing$  2 and 16 mm, bradawl/pencil.

Recommended fasteners: 4,0 x 40 mm

### Mounting position

left or right

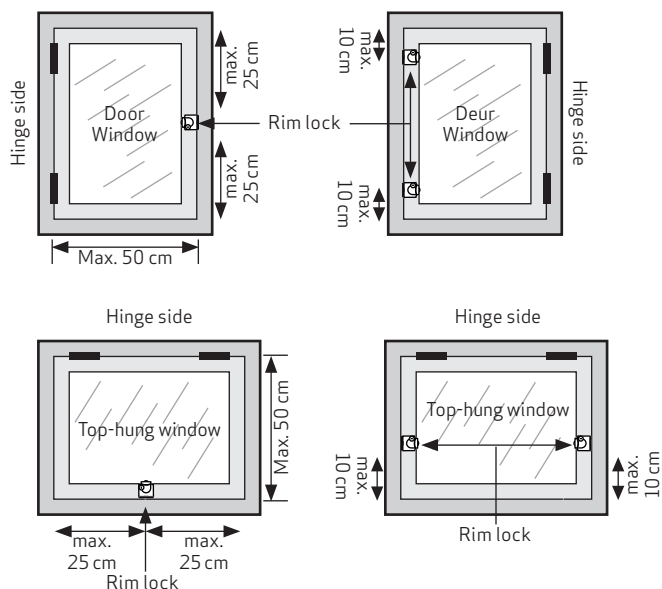

### Minimum installation space required

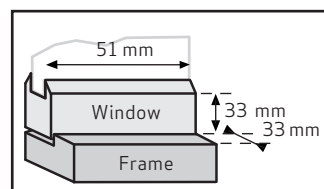

## User manual

### Open

Insert the key into the lock and turn it approximately 60° counterclockwise. The lock will spring open.

### Close

Push the lock shut using the push button. The key is not required for this.

### Maintenance

Regularly (at least once a year) spray the cylinder and mechanism with lock spray.



# AXA HOME SECURITY

## Rim lock 3012

EN



## Installation manual

The instructions below must be followed closely in order to effectively install and operate this product.

- 1 Close the window properly.
- 2 Place the lock on the window and keep 8 mm between the frame and the lock. (figure **A**).
- 3 Mark the screw holes of the lock.
- 4 Screw the lock onto the window (figure **B**) using the screws (4.0 x 40 mm, pre-drill Ø 2 mm) in the order shown.
- 5 Press the push button so that the centre point on the bolt makes a dent in the window frame.
- 6 Open the window.
- 7 Drill precisely at the location of the dent, using a drill bit with a diameter of 16 mm, to a depth of 23 mm.
- 8 Press the locking cup into this hole (figure **C**).
- 9 Screw the locking cup in place with the screws (4.0 x 40 mm, pre-drill Ø 2 mm) on the window frame (figure **C**).



**These screws must be screwed into the frame at an angle for optimum security.**

- 10 Make sure the lock is open and then press the cover cap onto the lock (figure **D**).

