

**AXA** HOME SECURITY

**EN**

# Curve Plus Security fitting

Self-adjusting Core Pull Protection

## Information

You have just acquired a high quality AXA product. The instructions below must be followed closely in order to effectively install and operate this product.

### Application

Exterior doors

### Installation tools (recommended)

(Battery) drill, screwdriver, drill Ø 8 and Ø 13 mm, allen key 3 mm, 14 mm spanner, awl/pencil.

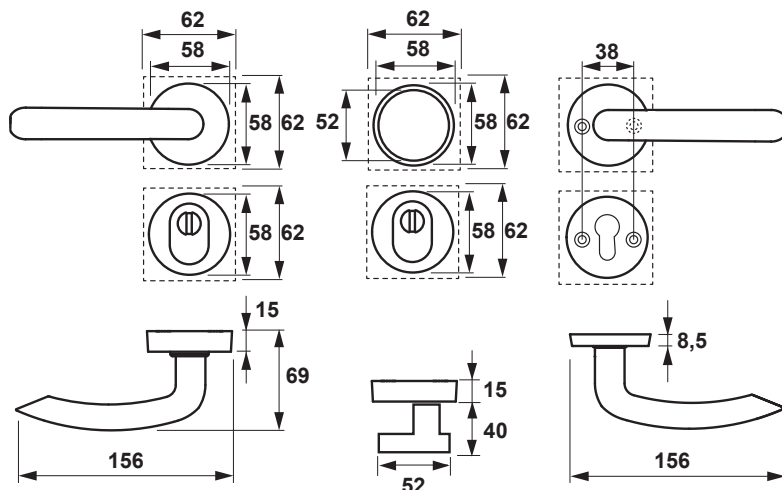
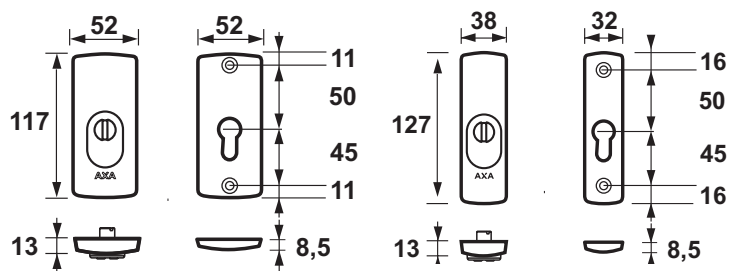
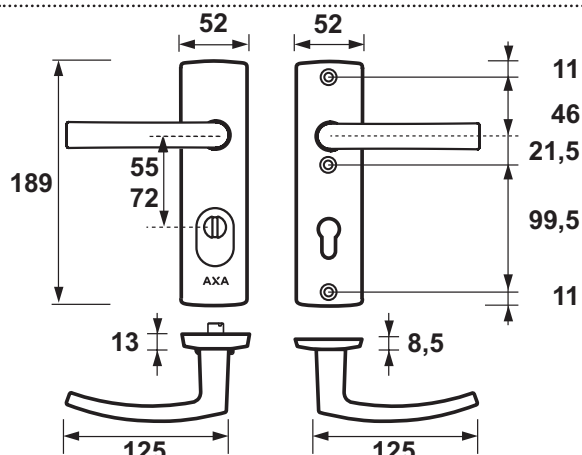
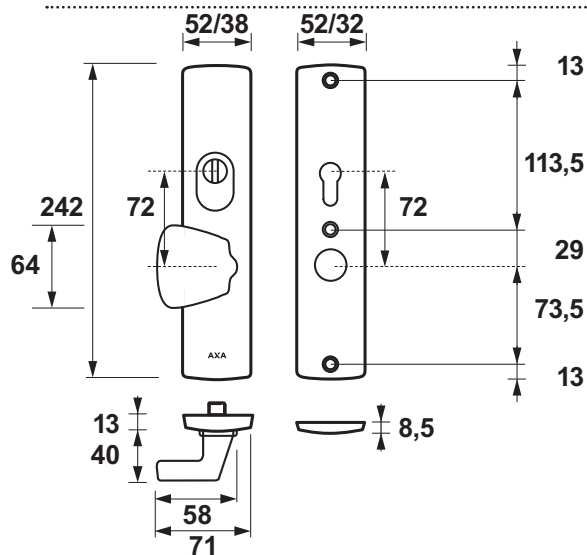
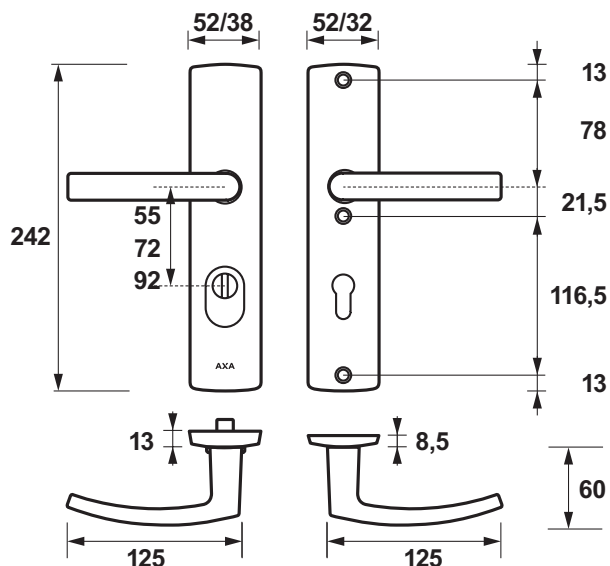
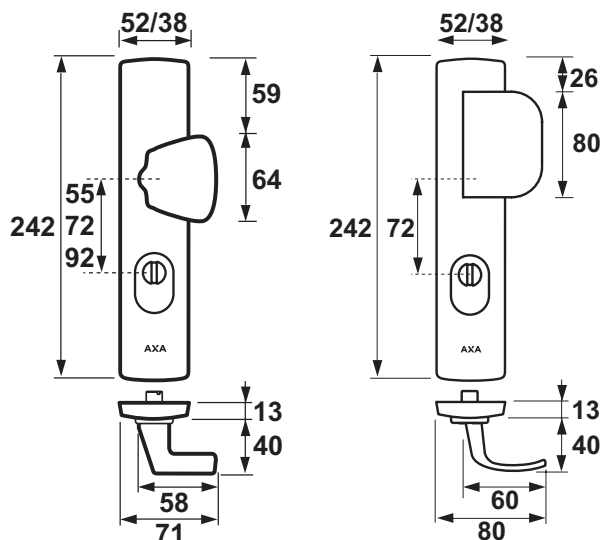

**AXA** HOME SECURITY

**EN**

# Curve Plus Security fitting

## Self-adjusting Core Pull Protection



The Euro profile cylinder may be mounted for the security backplate on the outside between 9 mm and 15 mm (B, C, D, F, G) protruding or with a round/square rosette 12-18 mm (H, I) protruding.



The Self-adjusting Core Pull Protection automatically adjusts to the projection length of the Euro profile cylinder.

## Installation manual

- 1 Place the drill template over the cylinder (figure A).
- 2 Insert the spindle through the template via the handle hole in (figure A).
- 3 Repeat steps 1 and 2 on the other side of the door.
- 4 Remove the drilling template and dismantle the cylinder and lock.
- 5 Drill through the markings on the outside with a Ø 13 mm drill bit to a depth of 15 mm. Then continue drilling with an 8 mm drill bit until halfway through the door or the lock case. Drill through the markings on the inside with an 8 mm drill bit until halfway through the door or the lock case.
- 6 Reattach the lock and profile cylinder to the door.

### Handle Security fitting, backplates, rosettes

(figure B, C, D, I)

- 7<sup>A</sup> Place the outer backplate/rosette (2) including draught seal (10) (moisture/draught stopper) on the door from the outside.
- 8<sup>A</sup> Secure the inner backplate/rosette (4) including the draught seal (11) to the outer backplate using the bolts provided.

### For sets complete with handle (figure D, I)

- 9<sup>A</sup> Mount the handle part (1) (figure E), with the screw hole in the collar of the handle, on the spindle (6) with the grub screw (15).
  - Up to a door thickness of 40 mm in position III.
  - Between door thicknesses 40 mm and 54 mm in position II.
- 10<sup>A</sup> Place the handle part with the spindle on the door from the outside.
- 11<sup>A</sup> Mount the other part of the handle (5) on the spindle (6) using the grub screw (7).

### S-Knob- en Knob Security fitting (figure F, H),

### Pusher Security fitting (figure G)

- 7<sup>B</sup> Secure the knob with the knob spindle (6) and ring (convex side of the ring facing you, figure F, H) to the backplate (2). Or turn the push spindle (6) on the threaded hole of the backplate (figure G). Tighten the spindle securely with a 14 mm spanner.
- 8<sup>B</sup> Place the pusher-/knob-/S-knobbackplate (6) including draught seal (10) on the outside of the door and attach it to the inner backplate (4) including draught seal (11) using the bolts supplied (8).
- 9<sup>B</sup> Mount the handle (5) on the knob/push spindle (6) with the grub screw (7).

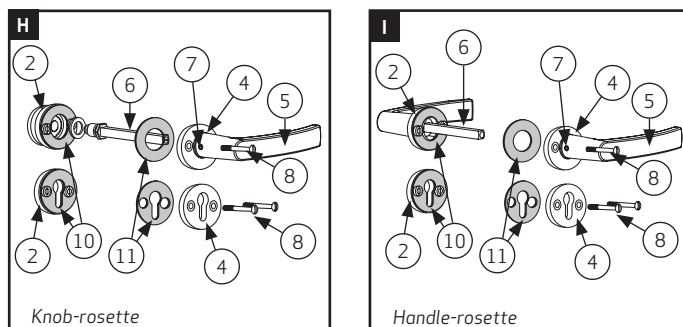
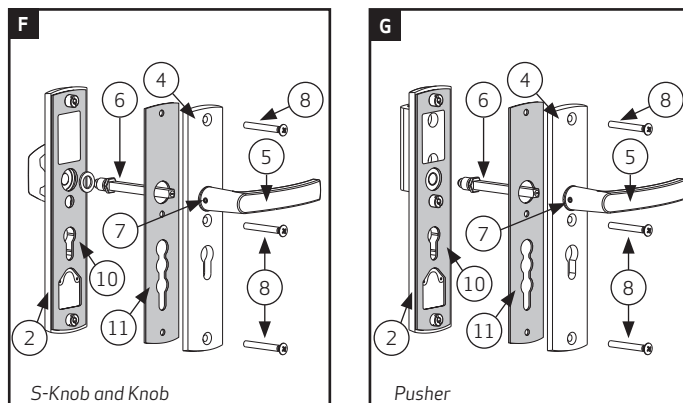
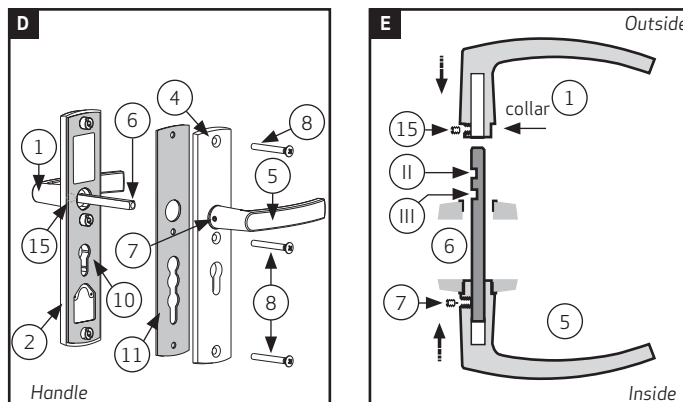
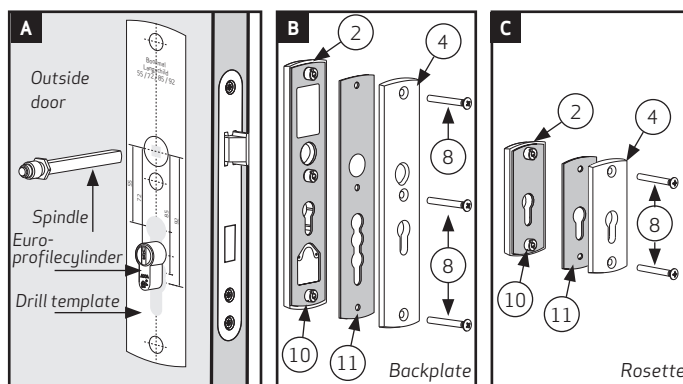

To comply with SKG\*\*\* certification, it is necessary to always combine an AXA Security Outer backplate with a matching AXA Security Inner backplate.