

AXA

AXA Remote 2.0

Remote-controlled window opener



for top-hung roof windows
for top-hung/centre-pivot roof windows
Velux new generation

You have just acquired a high quality AXA product. The instructions below must be followed closely in order to effectively assemble and operate this product.

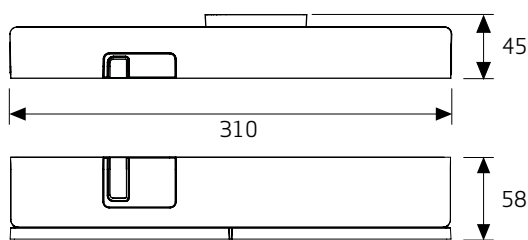

Assembly location:

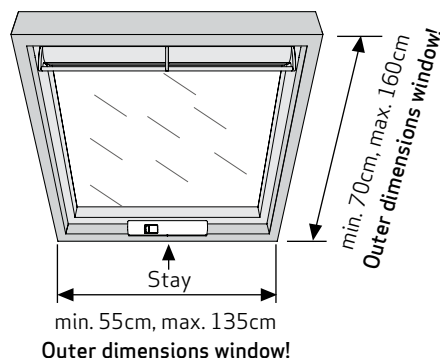

Implementation:

Top-hung roof windows, Top-hung/Centre-pivot roof windows Velux new generation (letter K) new: GPL MK06 old: GPL M06

Characteristics

Velux new generation

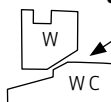

The frame is at a slant and has no sill

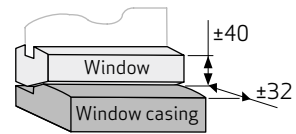

Assembly tools (recommended):

Tape measure, (cordless) drill, screwdriver, Ø 2 mm drill bit, pencil or stiletto, screw ring, hammer, Torx-TX20 wrench, screw ring and socket wrench



Minimum window height: 30 cm.
Maximum range remote control: distance 10 m.

Parts to be used

- | | | |
|-----------------------------|-------------------------------|------------------------------|
| 1. (2x) AAA Batteries | 7. (1x) Large casing plate B | 13. (10x) Screws 4,0 x 40 mm |
| 2. (4x) AA Batteries | 8. (1x) Small casing plate | 14. (4x) Screws 4,2 x 32 mm |
| 3. (1x) Closing-unit | 9. (1x) Connection support LW | 15. (2x) Bolts M4 x 16 mm |
| 4. (1x) Cover | 10. (1x) Screw ring | 16. (3x) Bolts M4 x 12 mm |
| 5. (1x) Window casing plate | 11. (1x) Socket wrench | 17. (1x) Remote control |
| 6. (1x) Window plate | 12. (1x) Metal mounting plate | |

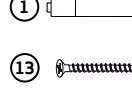
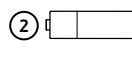
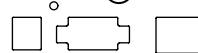
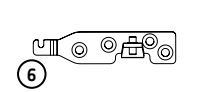
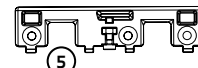
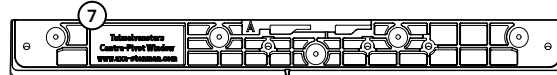
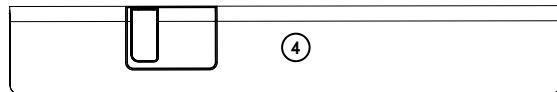

User manual

Remote control (figure A):

The remote control has 3 buttons: Open, Stop and Close. When the Open or Close buttons are pressed briefly, the window will fully open or close. When the Open or Close buttons are pressed continuously, the window will open or close as long as the button is pressed. When the Stop button is pressed, the movement will be stopped. Always point the remote control at the front of the closing unit (figure B).

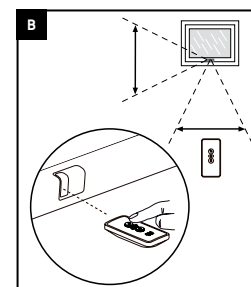
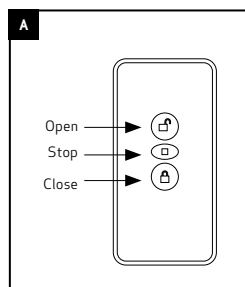

Configuring remote control:

- Place 2x AAA batteries in the remote control and 4x AA batteries in the closing unit (figure C).
- The LED light in the closing unit will come on for 20 seconds (green). Press the Open button (top button) on the remote control. The light will briefly turn off when configuration has taken place.

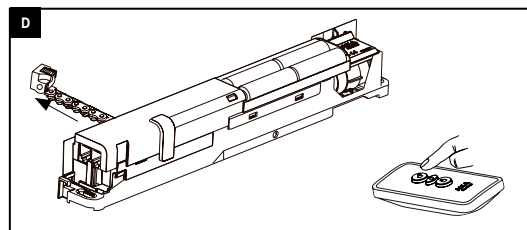
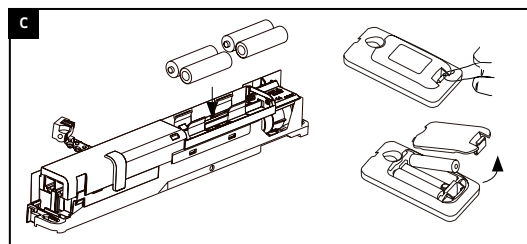



AXA

AXA Remote 2.0

Remote-controlled window opener
for top-hung, top-hung/centre-pivot roof windows

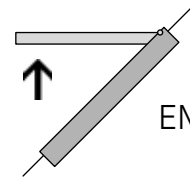

EMC 2004/108/EC



The configuration time is 20 seconds. The LED light will switch off once this time passes. If you want to configure the remote control or another remote control, you must briefly remove the batteries and then re-insert them. Then repeat step 2.



**- A remote control can be configured to an unlimited number of window units.
- A window unit can be configured to maximum 8 remote controls.**

- 3** Press the Open button again and allow the chain to fully exit the closing unit.
The closing unit is now ready for assembly (figure **D**).

Assembly manual

Assembly preparation

- 4** Install the screw hook **10** next to the handle, on the right (figure **E**). Then remove the cam stay (figure **F**).
5 Connect the two casing plates **B** **7** and **8** using connection support **LW** **9** (figure **G**).



Always use casing plates with B mark and connection support LW for top-hung roof windows

- 6** Place the casing plate set on top of the metal mounting plate **12** (figure **H**).
7 Mark the middle of the window on the window casing.
8 Close the roof window properly using the screw hook installed.
9 Position the casing plate set at the centre of the roof window. Make sure that the large casing plate **B** is placed flush against the frame and the small casing plate **B** is placed flush against the roof window (they must be at a 90° angle to one another, figure **I**).
10 Mark off the four holes for the metal mounting plate (figure **J**).
11 Pre-drill the holes (Ø 2 mm) and fix the metal mounting plate in place with screws **14** (4,2 x 32 mm, figure **K**).



When using a wireless drill, you must make the last few tightening revolutions by hand

Assembly

- 12** Re-position the casing plate set. Pre-drill the 5 holes for the large casing plate **B** (Ø 2 mm). Fix the casing plate in place using screws **13** (4,0 x 40 mm, figure **L**).

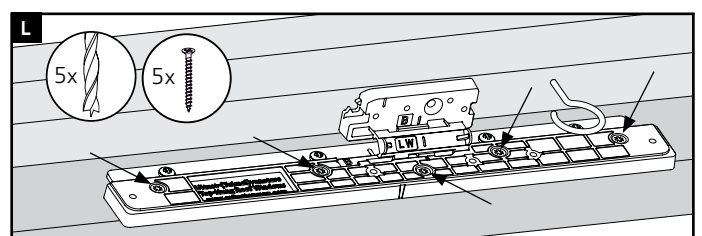
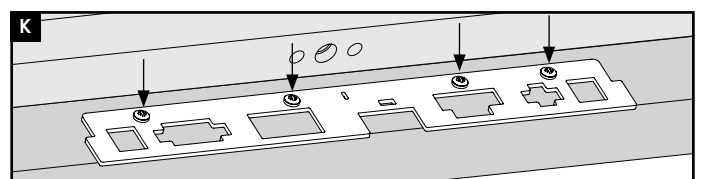
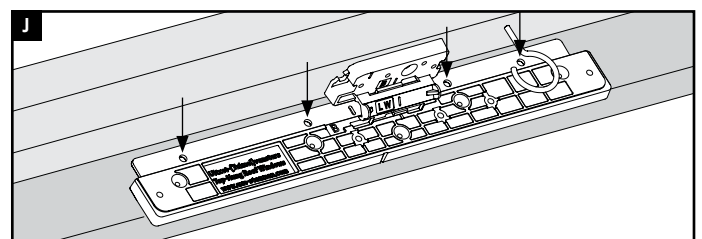
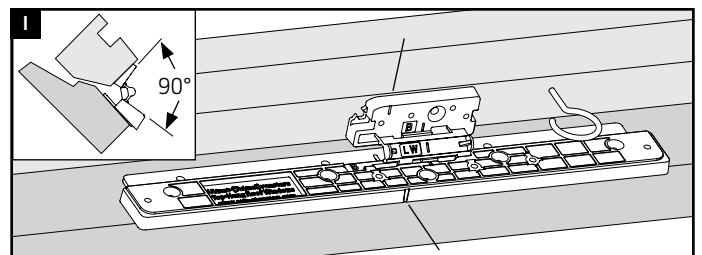
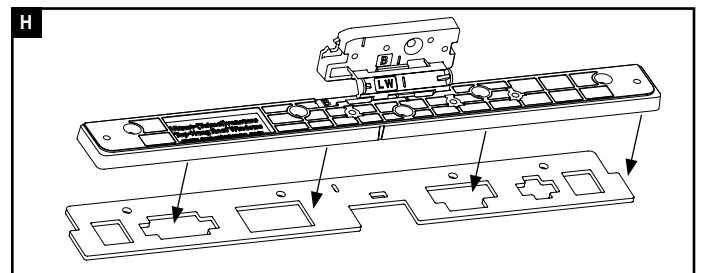
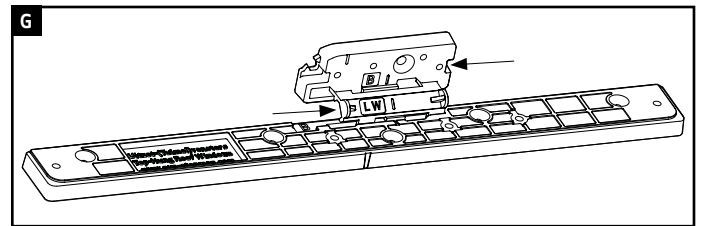
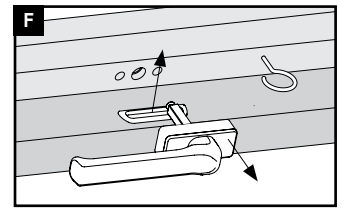
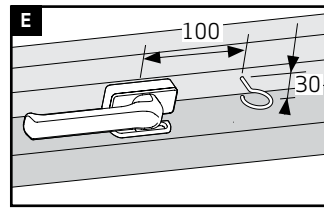



AXA

AXA Remote 2.0

Remote-controlled window opener
for top-hung, top-hung/centre-pivot roof windows

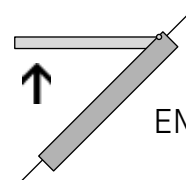

EMC 2004/108/EC

- 13** Pre-drill the the countersunk hole for the small casing plate B (\varnothing 2 mm). Fix the small casing plate B in place with screw **(13)** (4,0 x 40 mm, figure **M**).
- 14** Pre-drill the four remaining holes for the small casing plate B (\varnothing 2 mm). Fix the window plate **(6)** to the small casing plate B using the screws **(13)** (4,0 x 40 mm, figure **N**).
- 15** Remove the screw hook. Tap the connection support LW between the large and small casing plates B from right to left until it comes out, so the roof window can be opened again (figure **O**).
- 16** Attach de window casing plate **(5)** to the large casing plate B using 3 bolts **(16)** (M4 x 12 mm, figure **P**).
- 17** Slide the closing unit on to the window casing plate (figure **Q**).
- 18** Slide the chain block fully over the window plate (figure **Q**). The block will fix itself in place.
- 19** Screw the closing unit in place with 2 bolts **(15)** (M4 x 16 mm), one on the left-hand side and one on the right-hand side of the closing unit. Do not tighten the bolts entirely so the closing unit can be readjusted (figure **R**).
- 20** Close the window with the remote control figure **S**).



When doing so, hold the closing unit and ensure it stays the same distance from the window.

Configure closing unit:

- 21** The closing unit will stop flashing once it is fully closed. You can adjust the close-position using the adjustment screw.

If the window is not close enough:

If the window is not close enough (the window moves or a draft comes through the window), you must turn the adjustment screw to the left (figure **T**).

For effective operation and a long battery life-span, we advise not to configure the closing unit too tightly.

If the closing unit does not lock completely:

If the closing unit does not yet close properly, the LED light will flash. In this case, the unit is too tight.

If the closing unit has been configured too tightly, you must turn the adjustment screw to the right (figure **U**). Press the close button on the remote control once again and check whether the closing unit closes properly. Repeat this process until the unit closes properly.

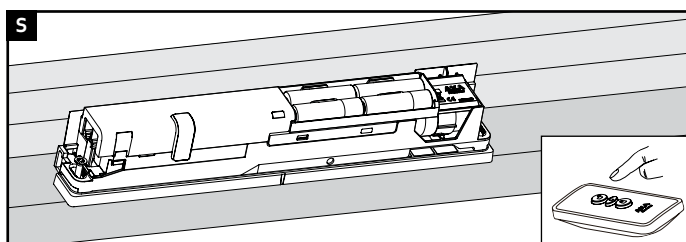
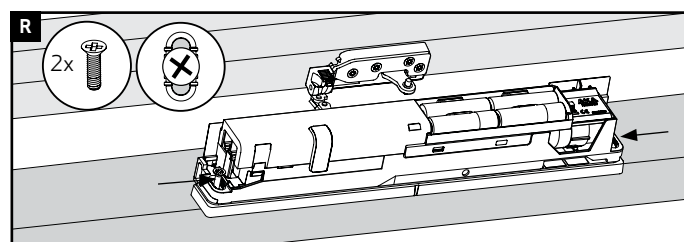
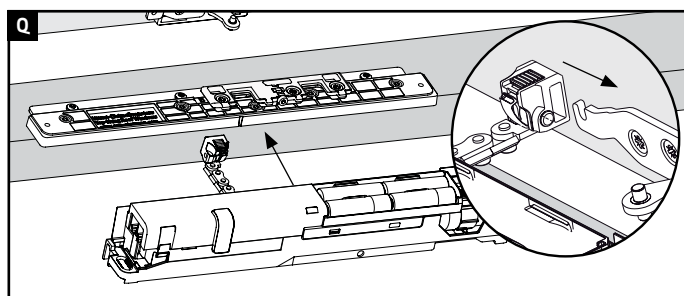
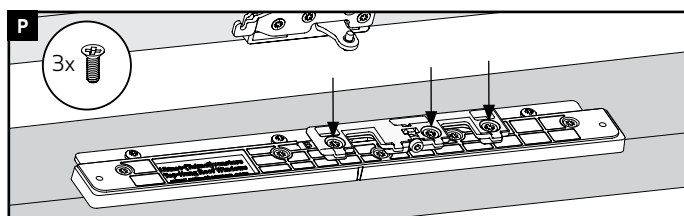
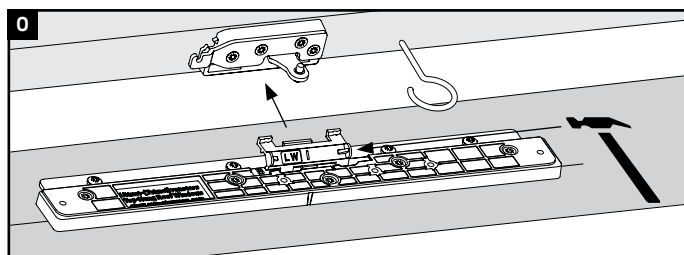
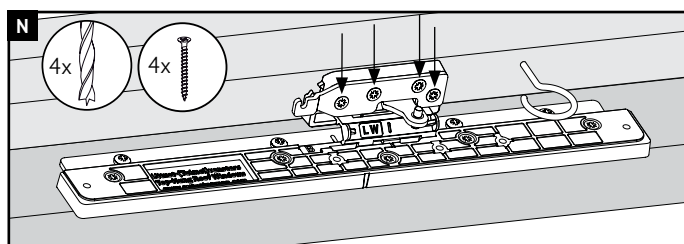
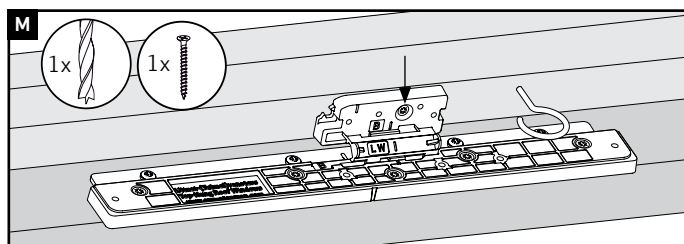



AXA

AXA Remote 2.0

Remote-controlled window opener
for top-hung, top-hung/centre-pivot roof windows

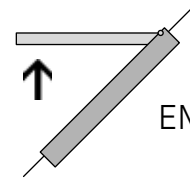

EMC 2004/108/EC

Final assembly

- 22 Then tighten the bolts on the left and right hand sides to secure the closing unit (figure **R**).
- 23 Once again, check whether the window opens and closes properly by fully closing and opening the window once. Repeat step 18 if the window does not flow or close properly.
- 24 Slide the cover **4** on to the closing unit, from front to back, until it goes no further (figure **V**).
- 25 The AXA Remote 2.0 is ready for use.

NB. The AXA Remote is only intended for items with a residential or office purpose.

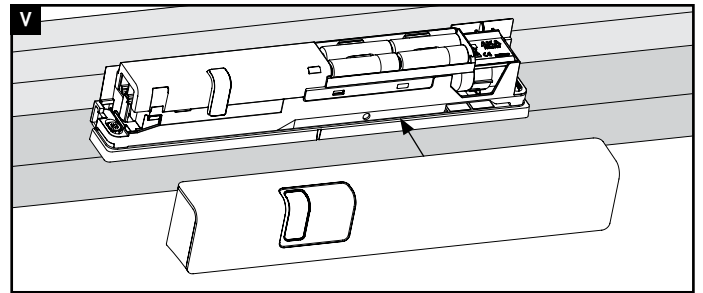
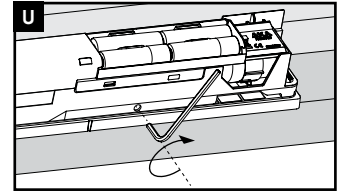
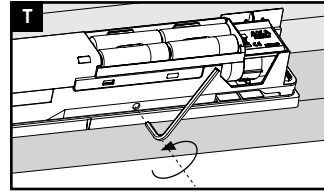

Problem-solving

The window does not close

- Disconnect the chain from the window and check that the window does not become stuck and operates without problems.
- Check that installation steps have been followed correctly.
- The batteries may be flat (have insufficient power). Replace the batteries in the unit and/or remote control (figure **C**).
- The unit has been configured too tightly. The closing unit may (for example, due to the wood setting or because of temperature differences) not properly close the window in certain cases, if it has been configured too tightly. Remove the 2 outer screws (figure **R**) from the closing unit. Turn the adjustment screw fully to the right (figure **U**). Repeat step 20 to/incl. 23. Mount the 2 outer screws on to the window unit once again.

The unit does not react or reacts insufficiently

- Temporarily remove the batteries or remove the adapter plug from the power socket and wait 2 minutes. Press a button on the remote control as if you are about to use the unit. Replace the batteries or the adapter. Now try to use the unit by pressing one of the buttons on the remote control.

Unit does not immediately respond to the remote control, sleep mode

- To save energy, the unit switches to sleep mode after a certain period of time; that is why you sometimes need to press twice on the remote control to activate the unit.
- Environmental factors could have an impact on the range of the remote control. Full sun, TL lighting very close to the front of the unit or a dusty/moist environment could reduce the operating range. In this case, you must move closer to the closing unit to operate it.
- The batteries may be flat (have insufficient power). Replace the batteries in the unit and/or remote control.

Replace batteries

Low-battery indicator

- If the LED starts to flash red/green intermittently, this means the batteries need to be replaced very soon. The AXA-Remote will always ensure that the last remaining power in the batteries is used to close the window.
- Open the cap of the unit and remove the 4 flat batteries. Insert 4 new batteries (AA) as identified in this assembly manual (figure **C**).



Only use good alkaline AA batteries (do not use rechargeable batteries)

Configure multiple units with the same remote control

- Briefly remove the batteries from the to-be-configured window unit or briefly remove the adapter from the power socket and wait 2 minutes. Replace the batteries or the adapter. Continue to configure the remote control so long as the LED light remains green (20 seconds) (see figure **C**).

Ventilation capacity

According to NEN 1087 and NEN 8087, which identify minimum ventilation per area, the AXA Remote 2.0 complies with the minimum ventilation capacity of 25 m³/hour per area, based on a window surface area of 0.26m². Due to its many opening possibilities, the AXA Remote 2.0 is also suitable for aeration. For the mentioned window size, each AXA Remote 2.0 is able to sufficiently ventilate an area of 22.5 m. The AXA Remote 2.0 also complies with the capacity guideline established in NPR 1088 because it enables continuous opening and closing. This allows the required ventilation to be arranged.